

# HOW TO INSTALL THIS TUBULAR LEVER LOCK

## 1 MARK DOOR & BORE HOLES

- Fold template over edge of door, mark site 60mm(2<sup>3</sup>/<sub>8</sub>"\*) or 70mm(2<sup>3</sup>/<sub>4</sub>"\*) of holes.
- Bore  $\varnothing 54\text{mm}$ (2<sup>1</sup>/<sub>8</sub>"\*) and  $\varnothing 25\text{mm}$ (1"\*) holes through door.
- Cut out a 58×26×3mm (2<sup>9</sup>/<sub>32</sub>"×1"×<sup>1</sup>/<sub>8</sub>"\*) base.

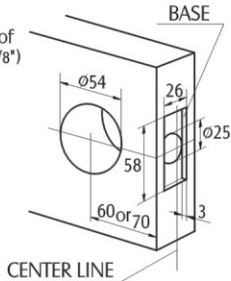

## 2 INSTALL LATCH

- Adjustable latch for 60mm(2<sup>3</sup>/<sub>8</sub>"\*) or 70mm(2<sup>3</sup>/<sub>4</sub>"\*) backset.

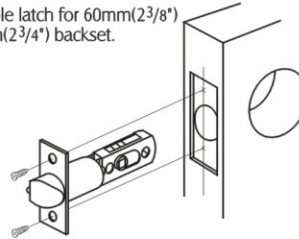

## 3 INSTALL LEVER

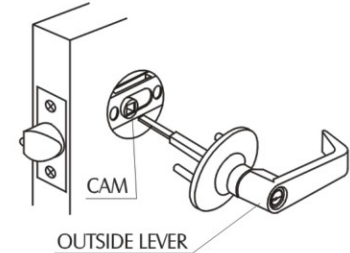

## 4 INSTALL INSIDE LEVER

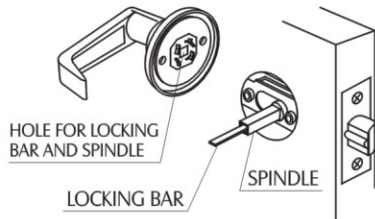

## 5 INSTALL STRIKE

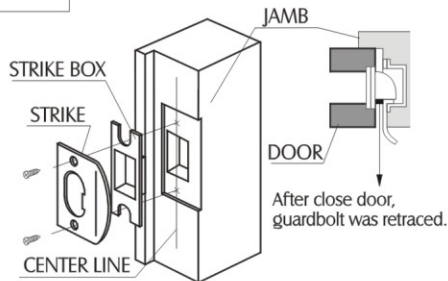

## INSTRUCTION FOR ADJUSTABLE LATCH

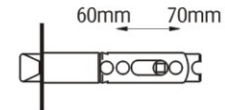

The cam is pushed fully to the right for 70mm(2<sup>3</sup>/<sub>4</sub>"\*) backset.  
(During the adjustment, keeping two teeth of the cam to forward always.)